



[Home](#)

[Contact](#)

[Info](#)

[Map](#)

[Search](#)

West Virginia Development Office

J.A. Wendling FoodService Building



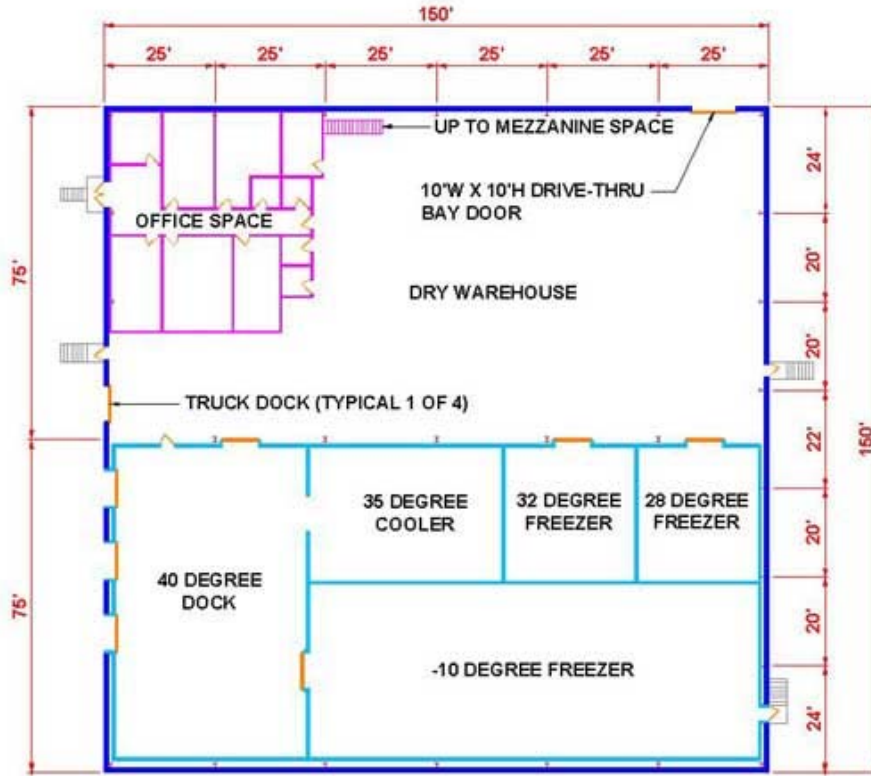

Location

City :	Pinch
County :	Kanawha
Miles To Nearest Interstate Or 4 Lane Highway:	5.0
Miles To Nearest Commercial Airport:	10.0
Rail Access :	None
Navigable Waterways:	None

Size and Utilities

Total Sq. Ft. :	22500
Avail Sq. Ft. :	22500
Avail Acreage :	3.0
Electric :	Appalachian Power Company
Water :	West Virginia American Water
Gas :	Mountaineer Gas Company
Sewer :	

Contact Information

Name :	Michael P. Thompson, SIOR,
--------	-------------------------------

	CRE
Company :	Realcorp, Inc.
Address :	3818 MacCorkle Avenue, SE Charleston, WV 25304
Phone :	(304) 925-7000
Fax :	(304) 925-7023
Email :	mpt@realcorpinc.com

[BACK](#)

Capitol Complex, Bldg. 6, Rm. 553 1900 Kanawha Blvd. E, Charleston, WV 25305-0311
Tel: 800.982.3386 304.558.2234 Fax: 304.558.0449

[Welcome to WV](#) | [Business Assistance](#) | [Real Estate](#) | [Small Business](#) | [International](#) | [Workforce Development](#)
[Community Matters](#) | [Media Center](#) | [Tourism Development](#) | [Who We Are](#)