



[Home](#)

[Contact](#)

[Info](#)

[Map](#)

[Search](#)

## West Virginia Development Office

### Owens Industrial Park Building 3



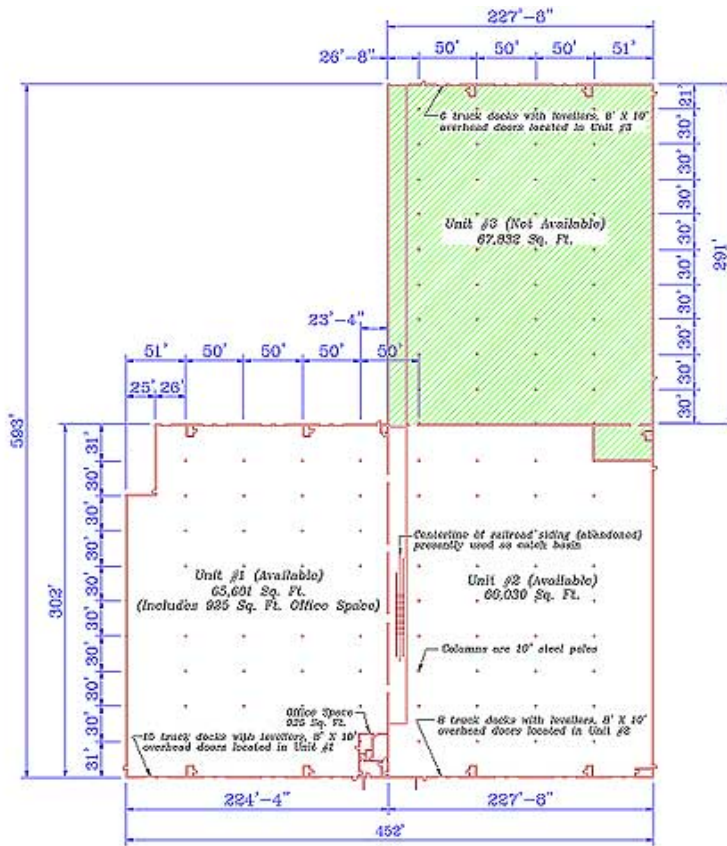

**Location**

City :	Charleston
County :	Kanawha
Miles To Nearest Interstate Or 4 Lane Highway:	0.5
Miles To Nearest Commercial Airport:	8.0
Rail Access :	None
Navigable Waterways:	Kanawha River

**Size and Utilities**

Total Sq. Ft. :	199462
Avail Sq. Ft. :	131630
Avail Acreage :	10.0
Electric :	Appalachian Power Company
Water :	West Virginin - American Water Company
Gas :	Mountaineer Gas Company
Sewer :	City of Charleston

**Contact Information**



<b>Name :</b>	Mary P. Casto, Vice President - Marketing
<b>Company :</b>	General Corporation
<b>Address :</b>	PO Box 6190 - 900 Pennsylvania Ave. Charleston, WV 25362- 0190
<b>Phone :</b>	(304) 343-2201
<b>Fax :</b>	(304) 343-2243
<b>Email :</b>	<a href="mailto:marycasto@genrlcorp.com">marycasto@genrlcorp.com</a>

[BACK](#)

---

Capitol Complex, Bldg. 6, Rm. 553 1900 Kanawha Blvd. E, Charleston, WV 25305-0311  
Tel: 800.982.3386 304.558.2234 Fax: 304.558.0449

---

[Welcome to WV](#) | [Business Assistance](#) | [Real Estate](#) | [Small Business](#) | [International](#) | [Workforce Development](#)  
[Community Matters](#) | [Media Center](#) | [Tourism Development](#) | [Who We Are](#)